

# THE ROSEWOOD Floor Plan

**MAIN FLOOR LAYOUT**  
**1,396**  
Main Floor Sq.Ft.

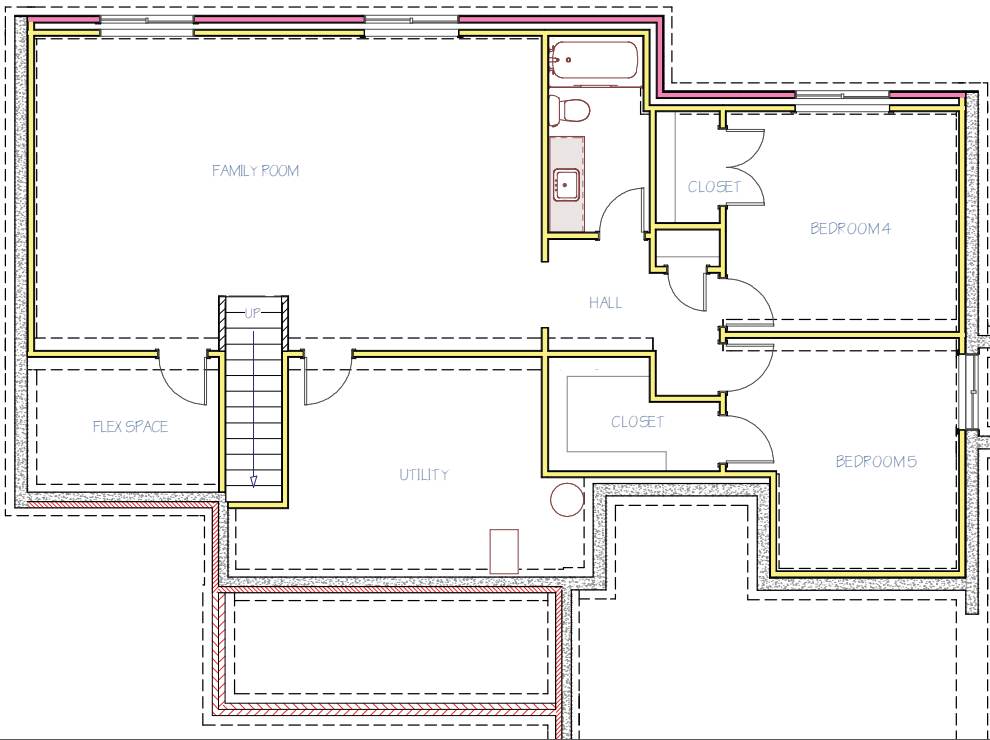

**POSSIBLE BASEMENT LAYOUT**  
**1,078**  
Unfinished View-Out  
Basement Sq.Ft.



Welcome Home!

*Designer Series Home*  
+ Included Luxury Options



14335 E. Laguna Ct.  
Wichita, KS 67230



ROSEWOOD | 3 | 2 | 3 | 1,396  
Floor Plan | Bedrooms | Bathrooms | Car Side-Entry Garage | Total Finished Sq.Ft.

### Why You Will Love This Home

- Gorgeous Modern Farmhouse Elevation with Great Curb Appeal
- Sprinkler System & Sod
- Great Outdoor Entertaining Space on the Composite Deck
- Quartz Countertops Throughout
- LVP Floors in Entry, Living, Dining & Kitchen
- Easy-to-Clean Vinyl Floors in Bathrooms & Laundry Room
- Large Kitchen with Walk-In Pantry & Large Island
- The Large Suite Features a Walk-In Shower & Walk-In Closet
- Potential for More Space in the Unfinished View-Out Basement
- Features: Energy Efficient Pella® Windows, Honeywell® Wi-Fi Thermostat, Chamberlain® myQ® Smart Garage Door Opener, 92% Energy Efficient Furnace with Better Indoor Air Quality & a Cooktop Vented to the Outside
- 1-Year Builder Warranty

### Community Benefits

- Community Pool
- Walking Paths
- Established Trees
- Large Stocked Ponds
- East Wichita Shopping
- Convenient Location



Disclaimer: The information contained herein is deemed reliable but cannot be guaranteed as to its accuracy. Current prices may change without notice and differ from what is indicated here. Floor plans, photos and graphics are for illustrative purposes and are only intended to be used as a guide. Illustrations may include upgrades and optional features. All information including square footage, bedrooms, bathroom and dimensions may vary from what is indicated here. We recommend to the buyer that any information of special interest, should be obtained through independent verification.

*Jon Nevarez*  
NEW HOME SPECIALIST  
C | (316) 670.9736  
Jon@MillerFamilyHomes.com

Contact Your New Home Specialist To Learn More: *Jon Nevarez* • (316) 347.3687 • Jon@MillerFamilyHomes.com

**DESIGNER**  
*Details*



BATHROOM B-SPLASH

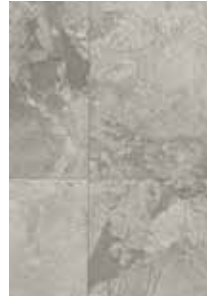

BATHROOM COUNTERTOP



BATHROOM FLOORS

BATHROOM PLUMBING FIXTURES: FINISH CHROME (INCLUDED FAUCET)

TUB/SHOWER FAUCET



VANITY FAUCET



TRIM: Pure White SW 7005



WALLS: Incredible White SW7028  
Matte

14335 Laguna Ct. - SL Rosewood  
EXTERIOR PAINT SPECIFICATION



Trim & Garage Door:  
Anew Grey SW 7030



Body: Incredible White SW7028

Brick: Mt Rushmore



INCLUDED APPLIANCES

Whirlpool Over The Range Microwave  
WMN51017NS



Whirlpool Dishwasher  
WDT730PAHZ



Whirlpool Range, Electric Range Cook  
WFE51050HS



200 KILBURN  
WILSON, NJ 07095  
201-947-4400



CABINETS - KITCHEN &  
BATH



LAUNDRY FLOOR



RIGHT ELEVATION



LIGHTING INTERIOR PACKAGE  
LAGUNA COLLECTION  
FINISH: FOREST BRONZE



BATHROOM  
ABOVE EACH SINK



LIVING ROOM



KITCHEN ISLAND  
x2



DISC LIGHT  
HALLWAYS  
LAUNDRY  
WALK-IN CLOSET



SECONDARY BEDROOMS



STAIRCASE



ENTRY



KITCHEN AREA  
& DINING ROOM  
RECESSED LIGHTS 3x



MASTER BEDROOM

Support Accent Lighting  
http://www.accentlighting.com/



KITCHEN COUNTERS,  
B-SPLASH & FAUCET

LVP - KITCHEN, LIVING & DINING

